

Falcon View



DEVELOPED BY

GROWTH-POINT
PROPERTIES



Contents

Falcon View

Location

Features for buildings 1-12

Site plan and floor plans

Contact us



Falcon View

Located within Centralpoint Innovation District, Falcon View is a new sectional title maxi unit park that offers ten units between 1,000m² and 1,300m² and an additional two units of approximately 2,300m² each.

Each unit features both office and warehouse space, with a first-floor mezzanine level that provides additional storage or office space. Competitively priced, and in an excellent location, Falcon View offers the perfect opportunity for you to own your space to thrive.



Location

Conveniently located off the N1 between Johannesburg and Pretoria in the Samrand area, Centralpoint offers fantastic accessibility to major transport routes. Surrounded by Waterfall City, Midstream and Centurion, it also has a very high residential component within a 5 km radius.

The park also features:

- Fibre to each unit
- Maintained landscaping and gardens throughout the precinct and within the park
- Close to medical facilities, schools and large shopping centres
- Easy access to the N1 & N14 highways
- 24/7 security patrol and off-site monitoring of the entire CentralPoint.
- Access control to the park

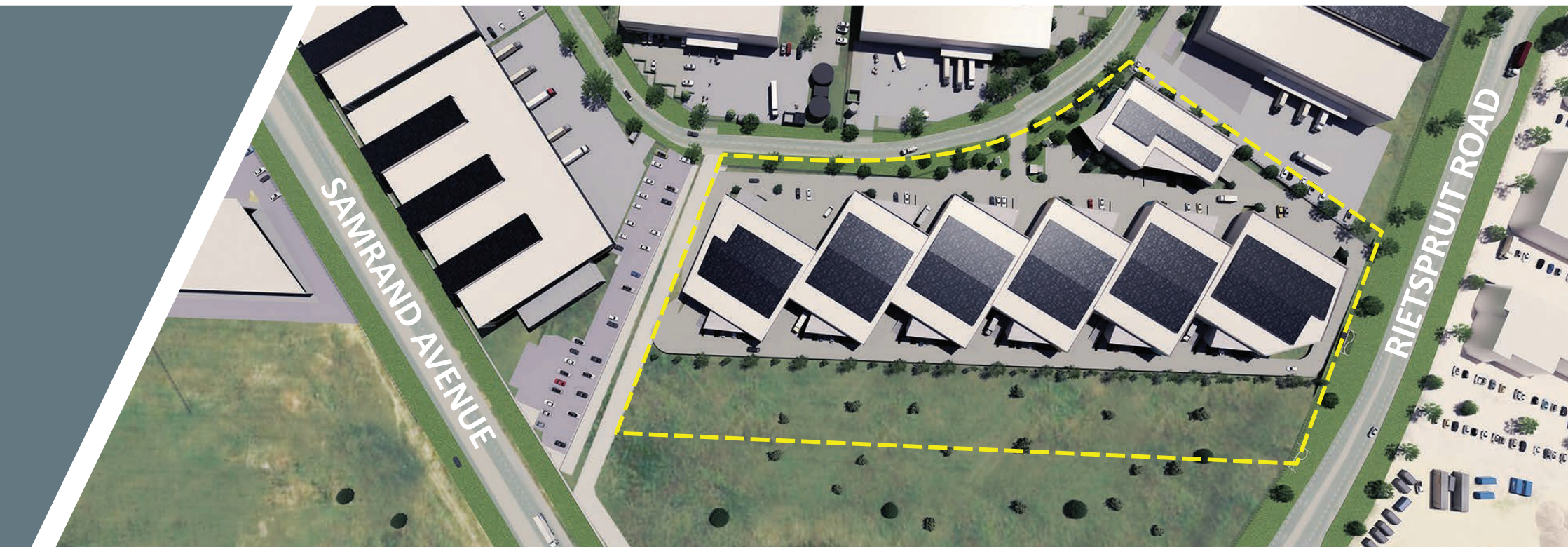

Features for buildings 1-12

- Each unit offers both office and warehouse components
- SANS degree of accuracy II warehouse floor
- Ample natural lighting
- Energy efficient LED lighting
- Energy-efficient air-conditioning in office areas
- Ongrade, concrete dock face options
- Dedicated parking bays per unit and spill-over parking available
- High spec security with electric fencing
- Flexibility in size and space planning
- Sprinkler protection available
- 6.5m spring height
- For specific details, refer to specifications document



Site plan and floor plans



Unit	Area	Type
1	1 054m²	Type C
2	993m²	Type D
3	2 426m²	Type E
4	1 333m²	Type A
5	1 324m²	Type B
6	1 333m²	Type A
7	1 324m²	Type B
8	1 333m²	Type A
9	1 324m²	Type B
10	1 333m²	Type A
11	1 324m²	Type B
12	2 262m²	Type F

UNIT 1

TYPE C

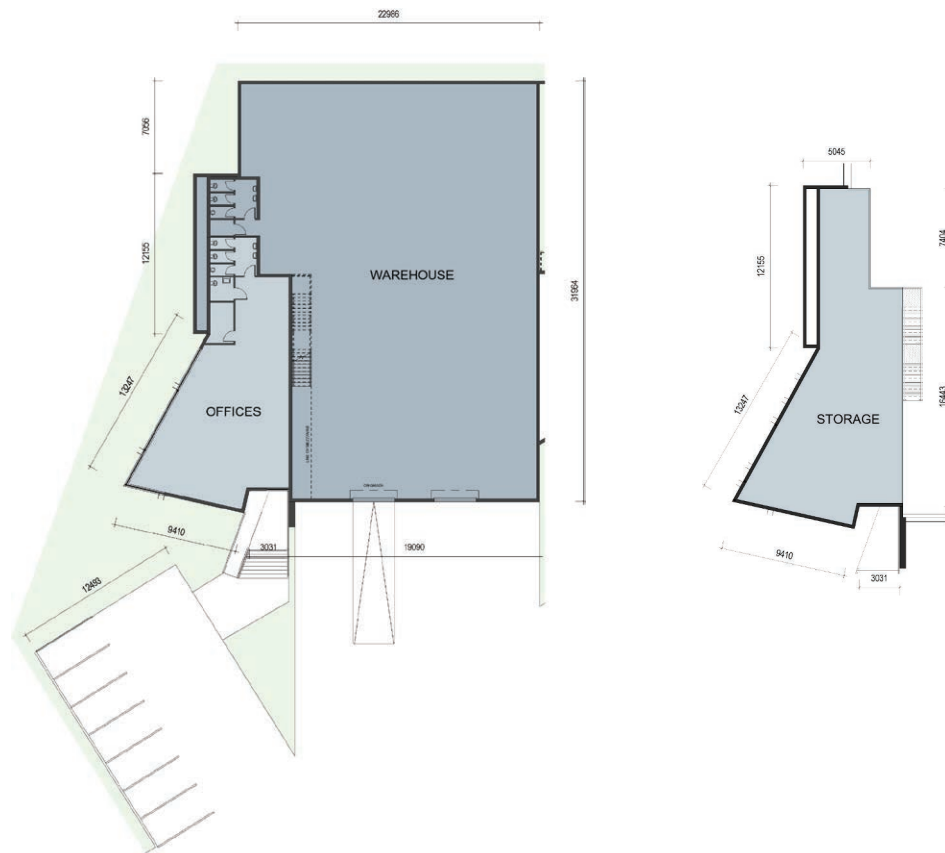

Unit Information

Warehouse	672m ²
Ground Floor Offices	146m ²
First Floor Storage	210m ²
Ablutions	26m ²
Total Area	1 054m ²

Roller Shutters	2
Dock levellers	1
Spring height	6.5m
HVAC to GF office	Yes
Exclusive use parking	4
Electricity Available	60kVA
Purchase Price	R 11,039,300

All prices exclude vat

UNIT 2

TYPE D

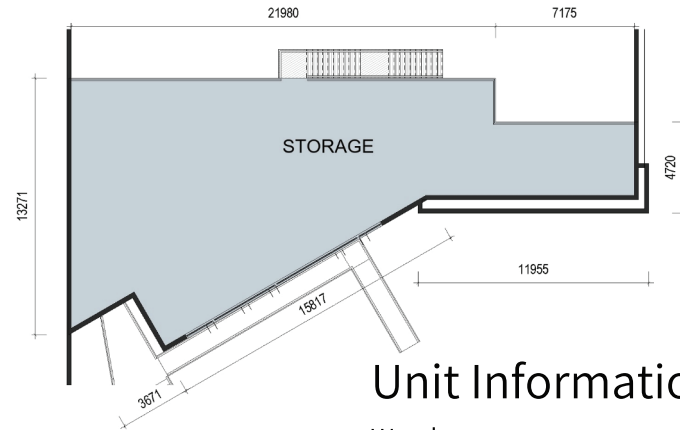
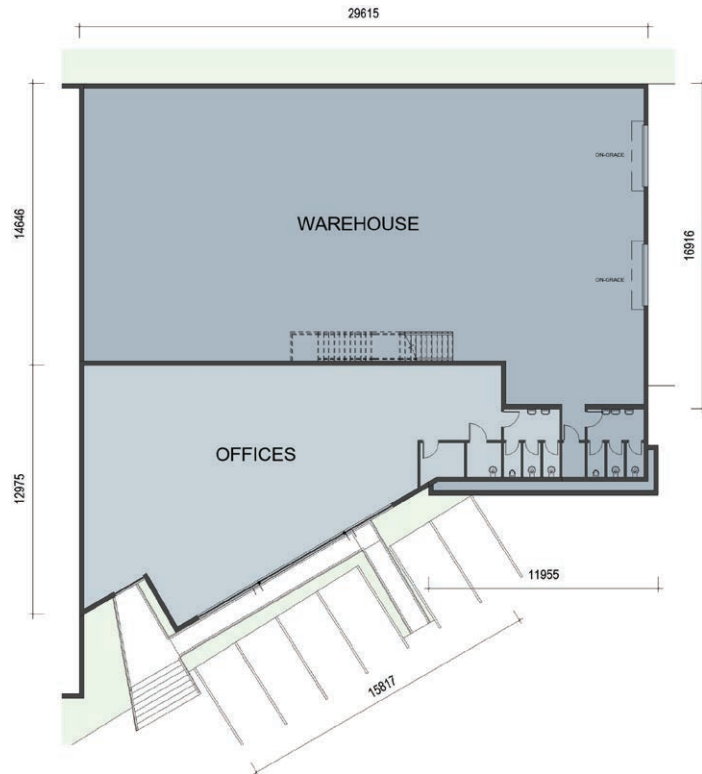

Unit Information

Warehouse	467m ²
Ground Floor Offices	213m ²
First Floor Storage	287m ²
Ablutions	26m ²
Total Area	993m ²

Roller Shutters	2
Dock levellers	0
Spring height	6.5m
HVAC to GF office	Yes
Exclusive use parking	6

Electricity Available	60kVA
Purchase Price	R 10,392,850

All prices exclude vat

UNIT 3

TYPE E

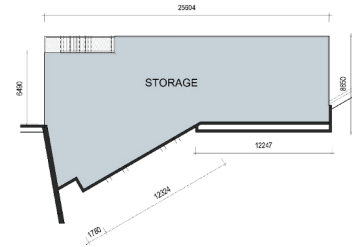
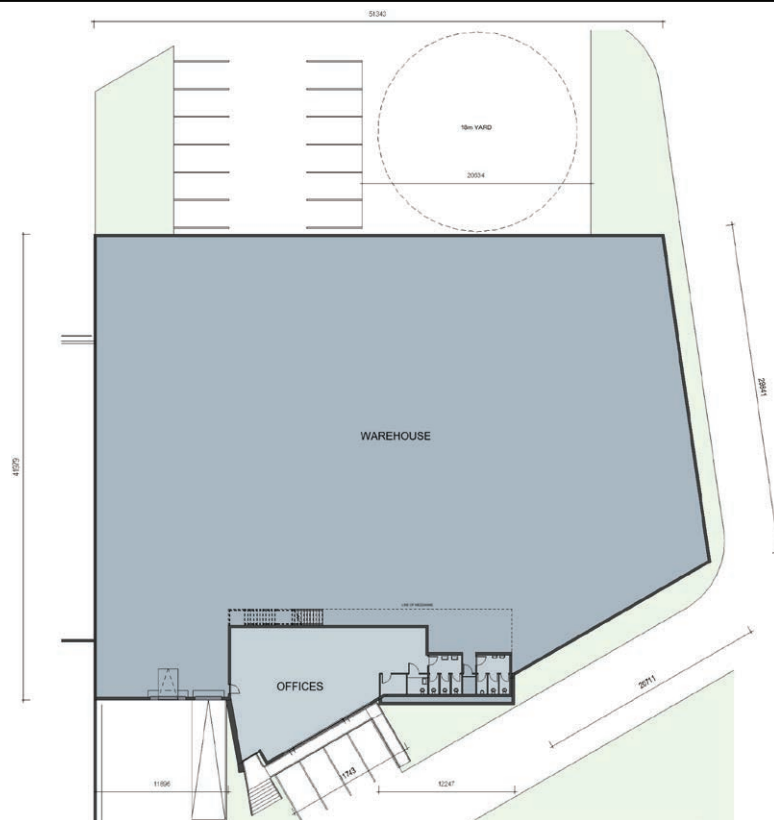

Unit Information

Warehouse	2 010m ²
Ground Floor Offices	154m ²
First Floor Storage	236m ²
Ablutions	26m ²
Total Area	2 426m ²

Roller Shutters	2
Dock levellers	1
Spring height	6.5m
HVAC to GF office	Yes
Exclusive use parking	16
Electricity Available	100kVA
Purchase Price	R 25,376,700
All prices exclude vat	

UNIT 4

TYPE A

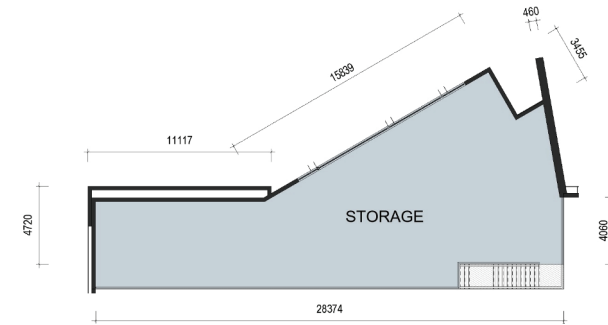
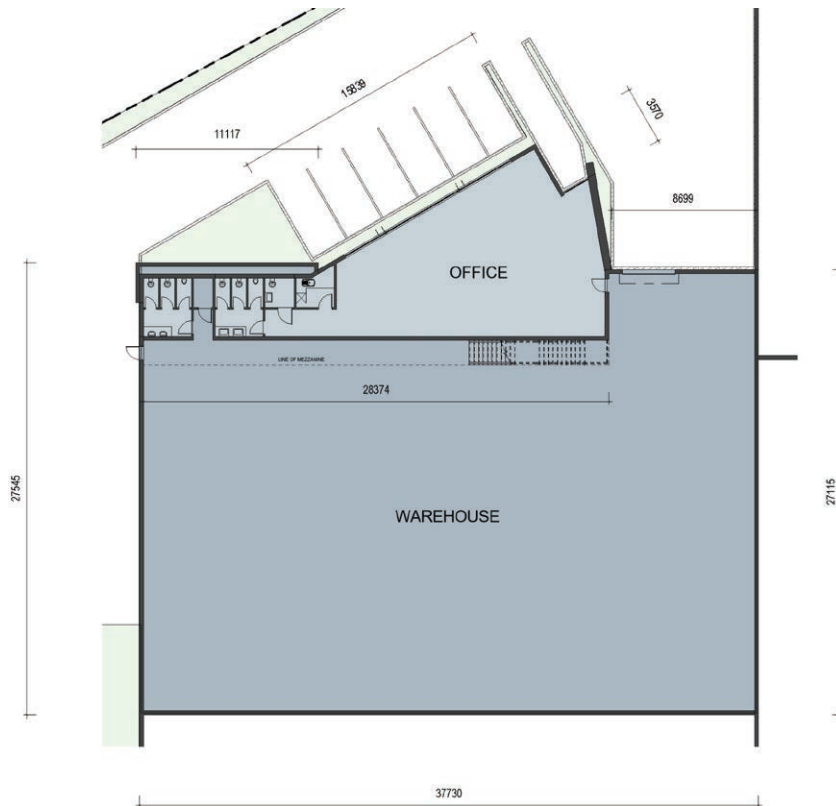

Unit Information

Warehouse	917m ²
Ground Floor Offices	154m ²
First Floor Storage	236m ²
Ablutions	26m ²
Total Area	1 333m ²

Roller Shutters	1
Dock levellers	0
Spring height	6.5m
HVAC to GF office	Yes
Exclusive use parking	9
Electricity Available	80kVA
Purchase Price	R 13,954,850

All prices exclude vat

UNIT 5

TYPE B

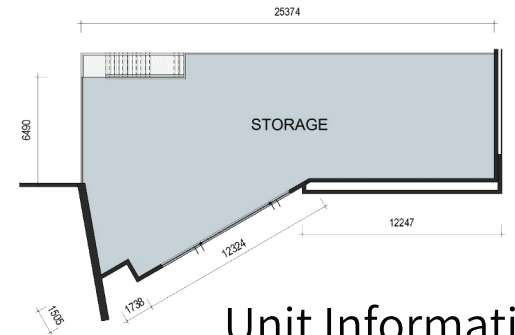
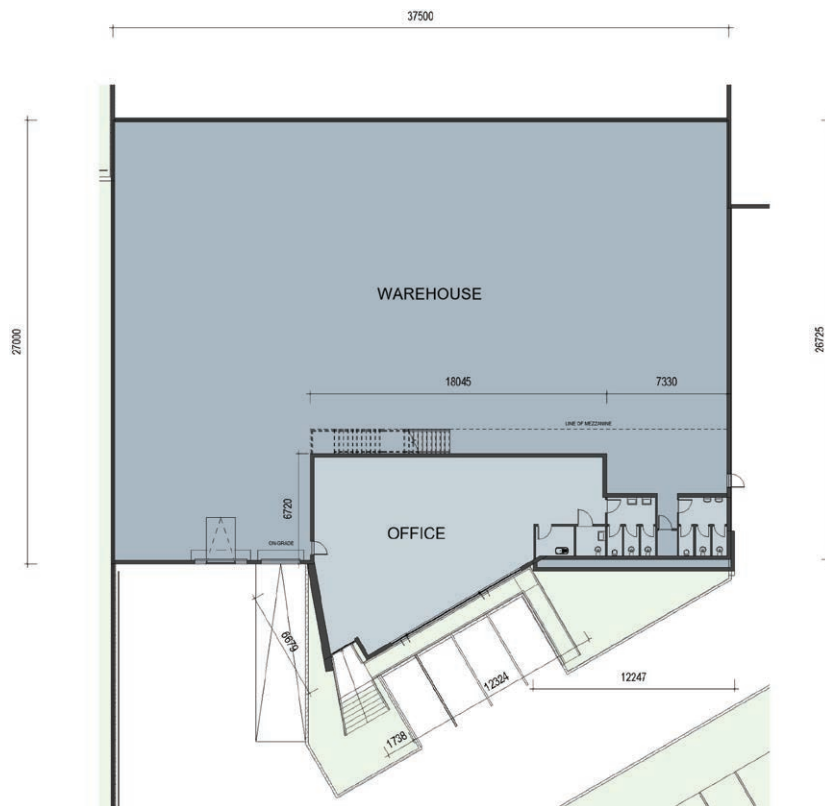

Unit Information

Warehouse	887m ²
Ground Floor Offices	158m ²
First Floor Storage	253m ²
Ablutions	26m ²
Total Area	1 324m ²

Roller Shutters	2
Dock levellers	1
Spring height	6.5m
HVAC to GF office	Yes
Exclusive use parking	4
Spill Over Parking	5
Underneath Powerline	
Electricity Available	60kVA
Purchase Price	R 14,191,800

All prices exclude vat

UNIT 6

TYPE A

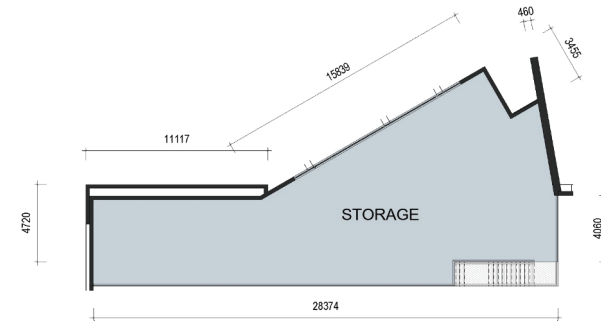
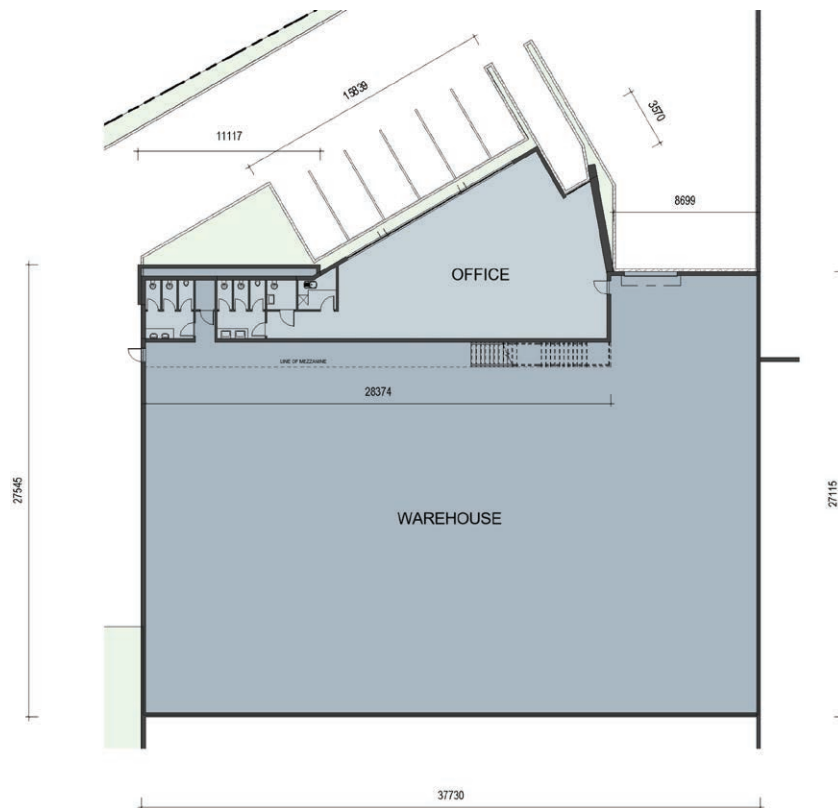

Unit Information

Warehouse	917m ²
Ground Floor Offices	154m ²
First Floor Storage	236m ²
Ablutions	26m ²
Total Area	1 333m ²

Roller Shutters	1
Dock levellers	0
Spring height	6.5m
HVAC to GF office	Yes
Exclusive use parking	9
Electricity Available	80kVA
Purchase Price	R 13,954,850

All prices exclude vat

TYPE B

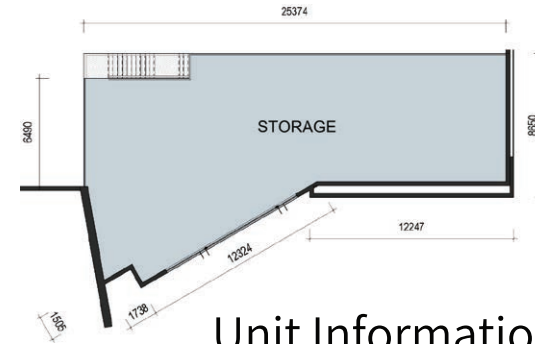

Warehouse	887m ²
Ground Floor Offices	158m ²
First Floor Storage	253m ²
Ablutions	26m ²
Total Area	1 324m ²

Roller Shutters	2
Dock levellers	1
Spring height	6.5m
HVAC to GF office	Yes
Exclusive use parking	4
Spill Over Parking	5
Underneath Powerline	
Electricity Available	80kVA
Purchase Price	R 14,191,800
	All prices exclude vat

UNIT 8

TYPE A

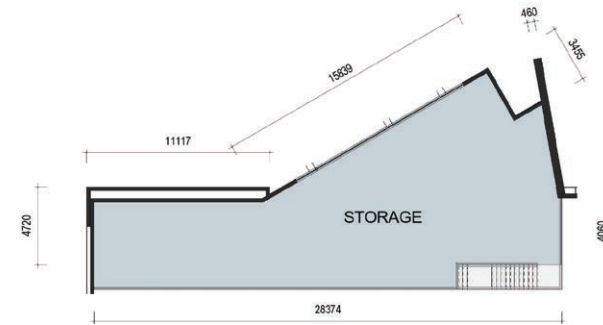
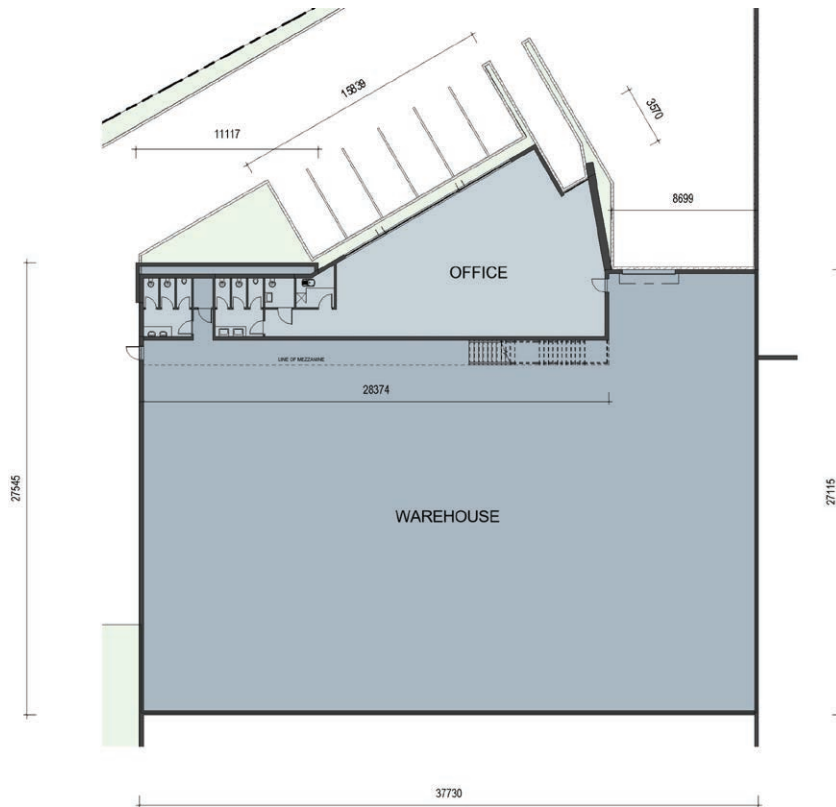

Unit Information

Warehouse	917m ²
Ground Floor Offices	154m ²
First Floor Storage	236m ²
Ablutions	26m ²
Total Area	1 333m ²

Roller Shutters	1
Dock levellers	0
Spring height	6.5m
HVAC to GF office	Yes
Exclusive use parking	9
Electricity Available	80kVA
Purchase Price	R 13,954,850

All prices exclude vat

TYPE B

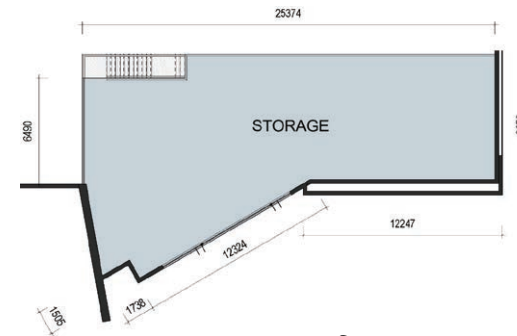

Warehouse	887m ²
Ground Floor Offices	158m ²
First Floor Storage	253m ²
Ablutions	26m ²
<hr/>	
Total Area	1 324m ²

Roller Shutters	2
Dock levellers	1
Spring height	6.5m
HVAC to GF office	Yes
Exclusive use parking	4
Spill Over Parking	5
Underneath Powerline	
Electricity Available	80kVA
Purchase Price	R 14,1

All prices exclude vat

UNIT 10

TYPE A

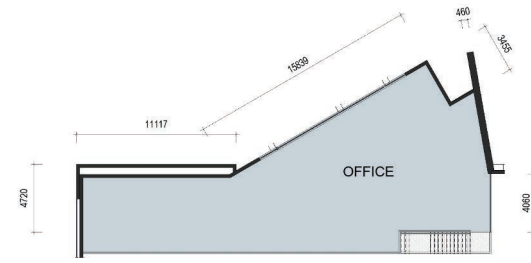
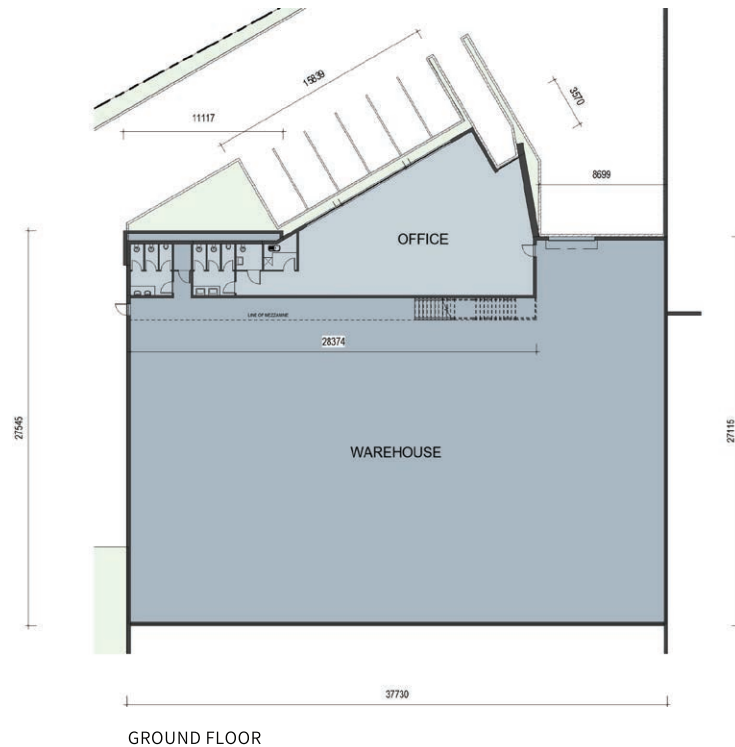

Unit Information

Warehouse	917m ²
Ground Floor Offices	154m ²
First Floor Storage	236m ²
Ablutions	26m ²
Total Area	1 333m ²

Roller Shutters	1
Dock levellers	0
Spring height	6.5m
HVAC to GF office	Yes
Exclusive use parking	9
Electricity Available	80kVA
Purchase Price	14,288,100

All prices exclude vat

TYPE B

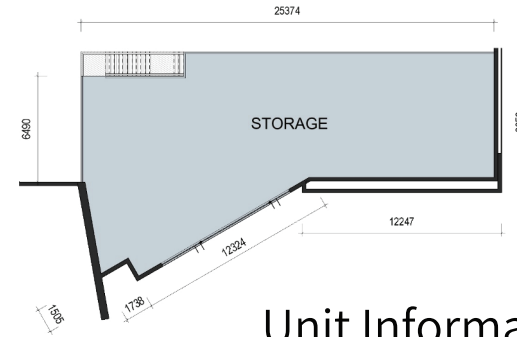
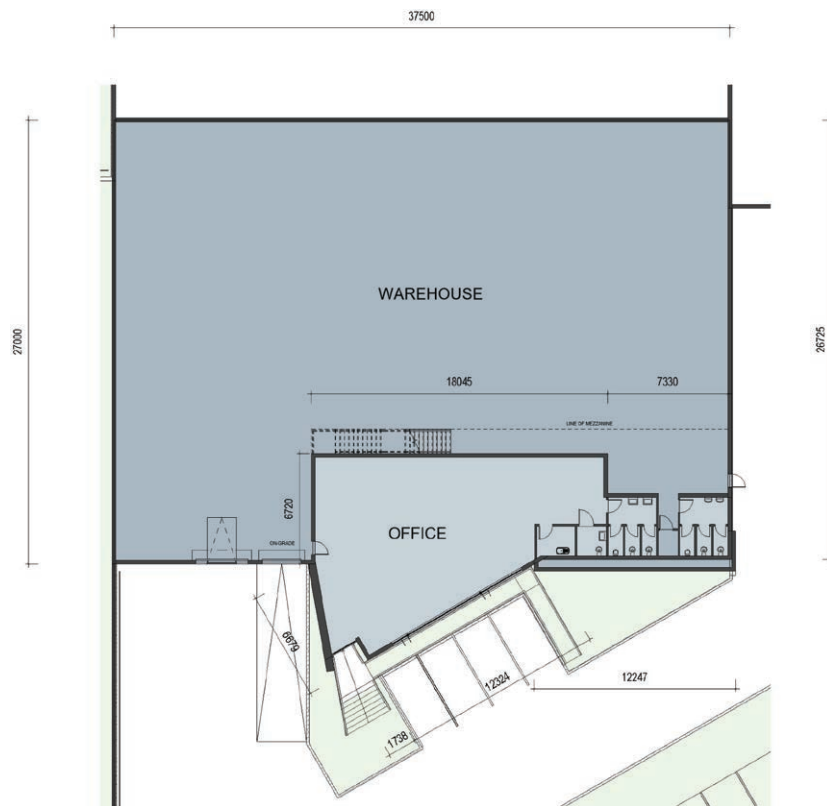

Warehouse	887m ²
Ground Floor Offices	158m ²
First Floor Storage	253m ²
Ablutions	26m ²
<hr/>	
Total Area	1 324m ²

Roller Shutters	2
Dock levellers	1
Spring height	6.5m
HVAC to GF office	Yes
Exclusive use parking	4
Spill Over Parking	5
Underneath Powerline	
Electricity Available	80kVA
Purchase Price	R 14,191,800
All prices exclude vat	

UNIT 12

TYPE F

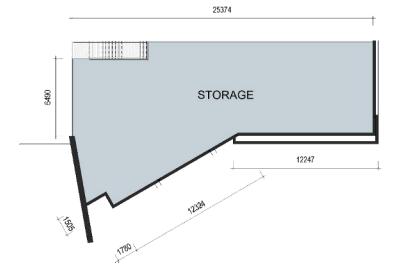
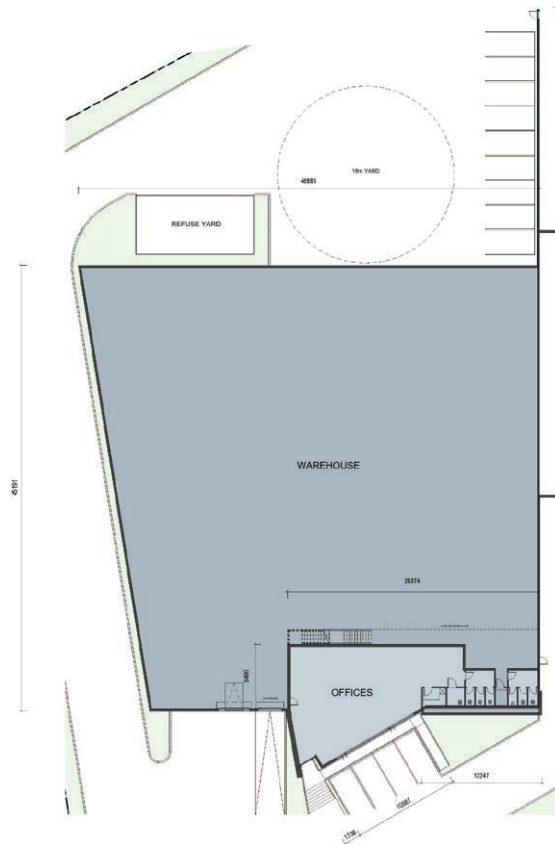

Unit Information

Warehouse	1 825m ²
Ground Floor Offices	158m ²
First Floor Storage	253m ²
Ablutions	26m ²
Total Area	2 262m ²

Roller Shutters	2
Dock levellers	1
Spring height	6.5m
HVAC to GF office	Yes
Exclusive use parking	13
Electricity Available	100kVA
Purchase Price	R 24,228,400

All prices exclude vat

Contact us

For more information, please contact
Zaak Fourie at ZFourie@growthpoint.co.za or call +27 73 524 3572.

Additional T&C's apply:

Standard Growthpoint documentation shall be used
The brochure does not constitute an offer
The information contained herein is confidential and intended for the client
Development proposals are subject to Growthpoint's board approval
All proposals are based on current layout plans and perspectives
A mandate on the property must have written approval from Growthpoint
All mandates are client specific (no general mandates)
We reserve the right to change any information herein without notice

DISCLAIMER: The information contained in this document has not been verified independently. No representation or warranty express or implied is made as to and no reliance should be placed on the fairness, accuracy, completeness or correctness of the information or opinions contained herein. Opinions represent those of the Growthpoint at the time. Undue reliance should not be placed on such statements and opinions because by nature, they are subjective to known and unknown risk and uncertainties and can be affected by other factors that could cause variation. Neither Growthpoint nor any of its respective affiliates, advisors or representatives shall have any liability whatsoever (based on negligence or otherwise) for any loss howsoever arising from any use of this information contained herein or its contents or otherwise arising in connection with this information and do not undertake to publicly update or revise any of the information whether to reflect new information or future events or circumstances otherwise.